

Cavi240

Type CFIS

- 240 minutes fire integrity rated stops
- Friction fit or upstand flap fit
- Accompanying moisture protection measures
- For cavity widths up to 100mm maximum

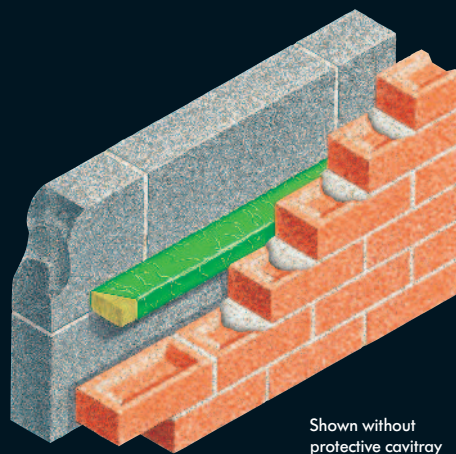

REQUIREMENT

To provide 4 hour fire rated acoustic cavity stop for use in cavity walls in intermediate and top of wall locations

SOLUTION

Non-combustible rock mineral insulator promoting acoustic and fire barrier qualities enveloped within a green poly-sleeve. May be compressed to suit cavities of most popular sizes. This product can also be supplied with an upwardly extending flap on one side of the encapsulation. This provides an alternative fixing option of securing to the inner skin should this be required. State clearly which version is required. Preformed trays (Arresting Barriers or Dropcloaks) available to provide deflective qualities within cavity.

REFERENCES

- BS 476 (fire resistance testing)
- Part E details – resistance to the passage of sound
- Building Regulations Document C L1 & L2
- Scottish Tech Standards Part D
- Robust Details
- PD6697:2010
- BRE Thermal Insulation Avoiding Risks

SPECIFY

Cavi 240 Type CFIS Cavicheck fire integrity stop by Cavity Trays of Yeovil Somerset BA22 8HU (01935 474769).

to suit cavity width ofmm supplied with / without encapsulation flap. (delete as required). Compress and friction fit within cavity and/or secure to inner skin utilising upstand flap following all accompanying instructions. Overlap adjoining lengths to maintain protection integrity. Specify if additional protection required

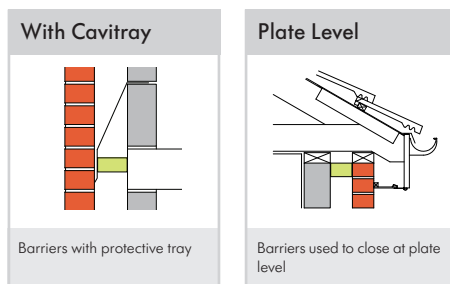
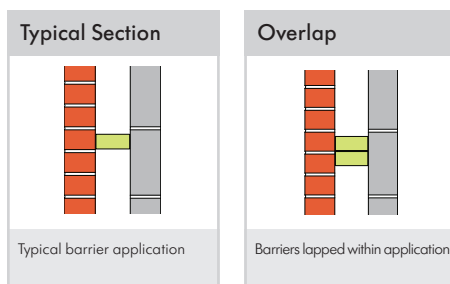
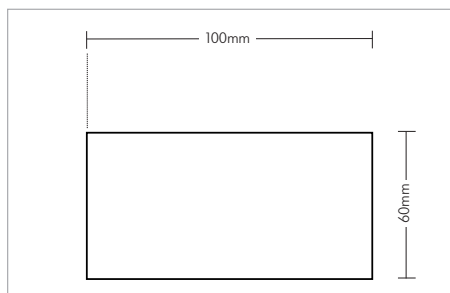

COMPUTER REFERENCE CODES: CFIS 1.2

PRODUCT NAME - GROUP

Cavi 240 Type CFIS

EXPOSURE RATING

Very severe

CAVITY - STANDARD SIZES ACCOMMODATED

Up to 100mm

SPECIAL CAVITY WIDTHS ACCOMMODATED

Yes – compression fit

COMMON CAVITY WALL APPLICATIONS

Yes – build in cavicheck as illustrated

CORNERS AND LINKS

Lap and butt options

PRODUCT SIZES

1.2m x 60mm x 100mm maximum

PROTECTIVE SLEEVING

Yes

ACTS AS INSULATOR

Yes – provides highest fire rating – see below

INSTALLED AS WALL IS RAISED

Yes – compresses for optimum fit in cured masonry

TRADITIONAL CONSTRUCTION

Fire rated closers tested in a cavity wall consisting of two masonry skins

MASONRY SKIN STYLES

Compresses to accommodate most skin finishes

ACOUSTIC INSULATOR

Yes – reduces direct and flanking transmission

FIRE RATED

Yes Cavi 240 prefix denotes 240 mins (4 hrs) rating

HORIZONTAL AND VERTICAL APPLICATIONS

Yes – horizontal and vertical uses

COMPATIBLE WITH OTHER CAVITY WALL ELEMENTS

Yes – DPC cavitray and caviweep compatible

SECURING TIES SUPPLIED

N/A - friction fit + any appropriate ties

PACK SIZES

Packs contain 10 lengths

WEIGHT PER PACK

7.5 kg

MATERIAL

Rock wool insulator within polysleeve

COLOUR

Green

BUILDING REGULATIONS

Yes regulations can be satisfied

NHBC

Yes requirements can be satisfied

'K' VALUE OF INSULATION USED

0.035W/mK

CFC FREE

Yes + zero ODP

CAD DRAWING DOWNLOADS AVAILABLE

Yes

DESIGNERS' COMMENTS

The four hour rating is the highest currently achievable in this style of barrier and permits the specifier to introduce a higher level of fire protection rating within the financial restraints normally associated with alternatives with lower ratings.

Every building that is divided into more than one area of different occupation must be designed and constructed in such a way that in the event of an outbreak of fire within the building, fire and smoke are inhibited from spreading beyond the area of occupation where the fire originated. 2.2 BR(S) – mandatory

Fire rated closers tested in a cavity wall consisting of two masonry skins. Where use is proposed where one skin is not of masonry, it is the users responsibility to ensure the proposed construction provides a level of stability, integration, performance and fire resistance and the resultant detail is fit for purpose and will perform to the standard created and determined by the user.

