

Cavi60

Type V170 Cavicloser

- One hour fire rating
- Cavity range 100mm to 170mm
- Acts as a DPC
- Closes and insulates reveal
- Acoustic reduction insulator

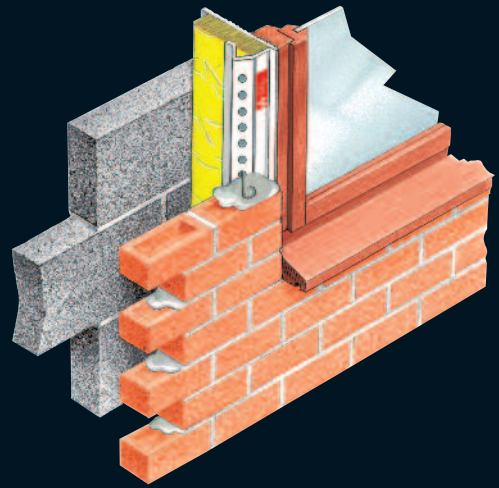

REQUIREMENT

To close a reveal with a wider cavity where a one hour fire rating is required in addition to the closing, thermal and dpc qualities.

SOLUTION

Cavities up to 170mm maximum can be economically closed with the Cavi 60 V 170 which has an acoustic reducing insulator facing into the cavity and an accompanying fire integrity rating of one hour.

REFERENCES

- BS 476 (fire resistance testing)
- Part E details – resistance to the passage of sound
- Building Regulations Document C L1 & L2
- Scottish Tech Standards Part D
- Robust Details
- PD6697:2010
- BRE Thermal Insulation Avoiding Risks
- BS EN ISO 6946:1997

SPECIFICATION WORDING

Cavi 60 Type V fire rated + acoustic cavicloser by Cavity Trays of Yeovil Somerset BA22 8HU (01935 474769) to close cavity wall reveal. Cavi 60 Type V to suit ____mm cavity. (enter appropriate cavity width dimensions).

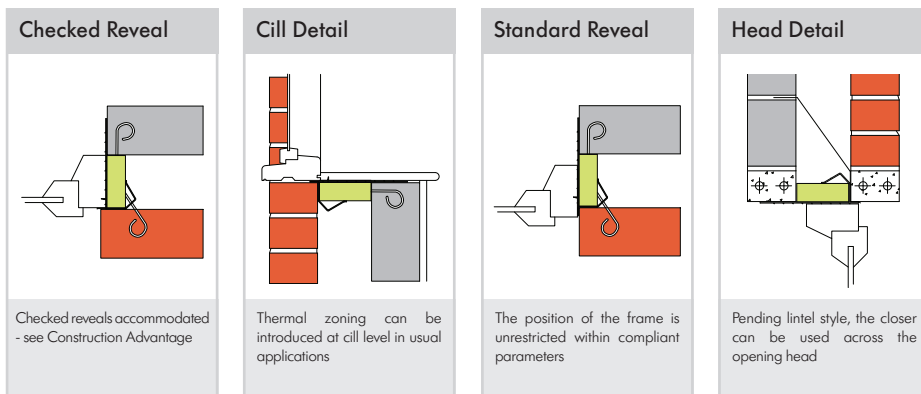

COMPUTER REFERENCE CODES:

CAVI 60 V170 2.1 50 CAVI 60V170 3.0 50
CAVI 60 V170 2.1 75 CAVI 60 V170 3.0 75
CAVI 60 V170 2.1 100 CAVI 60 V170 3.0 100

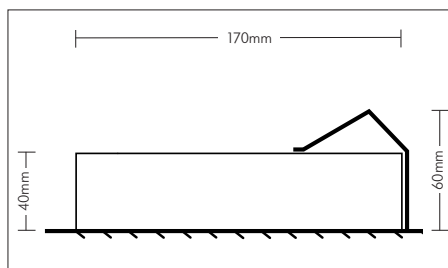

DESIGNERS' COMMENTS

Checked reveals instantly accommodated by turning the hinged section 90°. The resulting profile also introduces an isolation strip between the damp masonry and the section of the frame in check.

Fire rated closers tested in a cavity wall consisting of two masonry skins. Where use is proposed where one skin is not of masonry, it is the users responsibility to ensure the proposed construction provides a level of stability, integration, performance and fire resistance and the resultant detail is fit for purpose and will perform to the standard created and determined by the user.

PRODUCT NAME - GROUP

Cavi 60 Type V170 Cavicloser

EXPOSURE RATING

30+mm setback. Severe Very severe when checked

CAVITY - STANDARD SIZES ACCOMMODATED

From 100mm up to 170mm

SPECIAL CAVITY WIDTHS ACCOMMODATED

Yes – bespoke closer service state cavity width

STRAIGHT REVEALS

Yes – build in profile as supplied

CHECKED REVEALS

Yes – turn hinged section 90° prior to use

PRODUCT LENGTHS

2.1m, 3.0m

ACTS AS VERTICAL DPC

Yes

ACTS AS INSULATOR

Yes

PERMITS DIFFERENT FRAME POSITIONS

Yes

FRAMES FITTED AS WORK PROCEEDS OR LATER

Yes – first or second fix options

TRADITIONAL CONSTRUCTION

Fire rated closers tested in a cavity wall consisting of two masonry skins

MASONRY SKIN STYLES

All popular flat faced masonry

UNDULATING MASONRY FACE FINISHES

Seek advice providing details of material

ACOUSTIC INSULATOR

Yes reduces direct and flanking transmission

FIRE RATED

Yes Prefix denotes 60mins (1hr) fire integrity rating

VERTICAL AND HORIZONTAL APPLICATIONS

Yes – see examples

COMPATIBLE WITH OTHER CAVITY WALL ELEMENTS

No known restrictions

SECURING TIES SUPPLIED

Yes

PACK SIZES

Packs contain 6 lengths

WEIGHT PER PACK

2.1m x 6 = 13.5 kg. 3m x 6 = 19kg.

MATERIAL

PVCU + rock fibre insulator + stainless ties

COLOUR

White extrusion

BUILDING REGULATIONS

Yes regulations can be satisfied

NHBC

Yes requirements can be satisfied

'K' VALUE OF INSULATION USED

0.035W/mK

CFC FREE

Yes + zero ODP

CAD DRAWING DOWNLOADS AVAILABLE

Yes

